

US PAT. 6,109,617

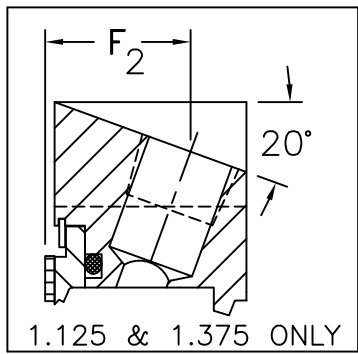

LARGE BORE ARRANGEMENT

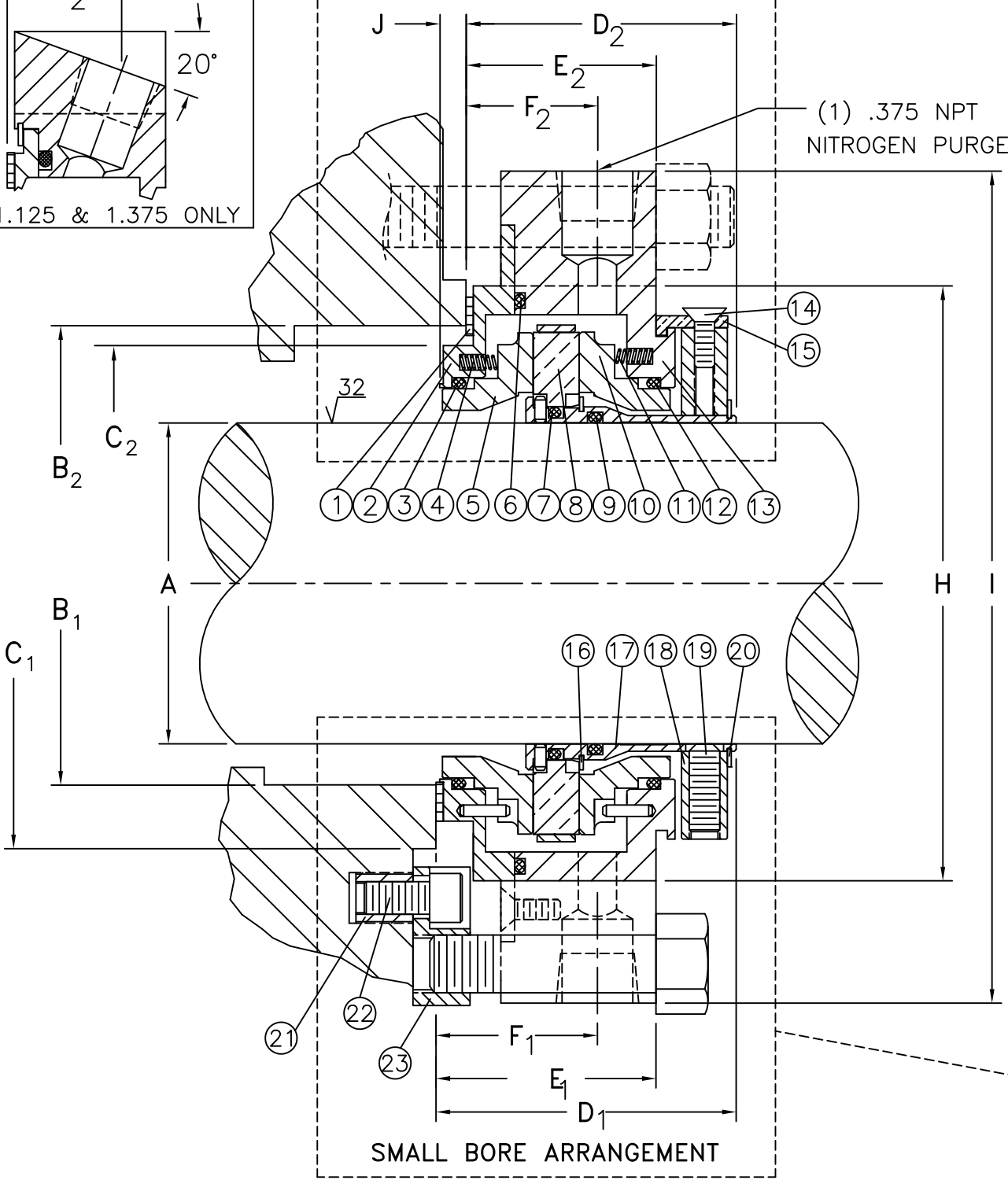

ITEM	DESCRIPTION
1	GASKET
2	GLAND ADAPTER
3	O-RING
4	SPRINGS
5	STATIONARY FACE
6	O-RING
7	O-RING
8	ROTARY FACE W/BAND
9	O-RING
10	STATIONARY FACE
11	SPRINGS
12	O-RING
13	GLAND
14	FLAT HEAD SCREWS
15	SETTING SPACERS
16	RETAINING RING
17	SLEEVE
18	COLLAR
19	SET SCREWS
20	RETAINING RING
<b>ADAPTER KITS 1,2,&amp; 3</b>	
21	THREADED INSERTS
22	CAP SCREWS
23	ADAPTERS

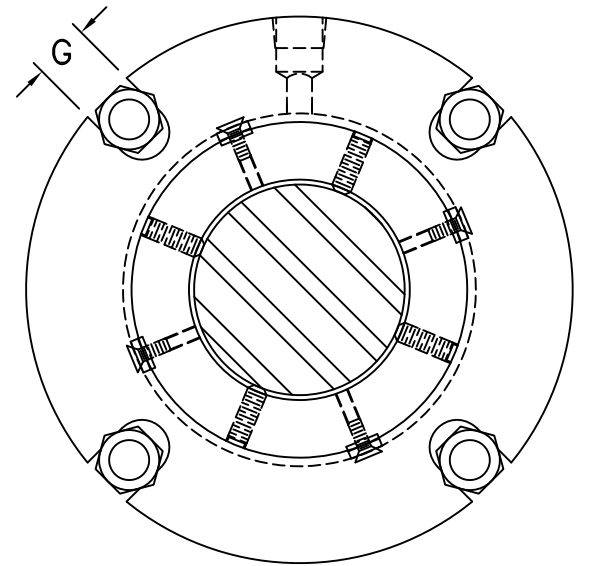

FOR SMALL BOLT CIRCLES  
**ADAPTER KIT 1** FOR  $\phi$ .500 STUDS  
**ADAPTER KIT 2** FOR  $\phi$ .375 STUDS  
**ADAPTER KIT 3** FOR  $\phi$ .625 STUDS

7000G SMALL BORE ARRANGEMENT

A	B <sub>1</sub> min.	B <sub>1</sub> max.	C <sub>1</sub> min.	D <sub>1</sub>	E <sub>1</sub>	F <sub>1</sub>	G	H	I		
1.750	2.390	2.750	2.656	2.46	1.80	1.32	.56	3.98	6.13		
1.875	2.515	2.875	2.781	2.46	1.80	1.32	.56	4.11	5.97		
2.125	2.765	3.125	3.031	2.46	1.80	1.32	.69	4.36	6.50		
2.500	3.140	3.500	3.406	2.46	1.80	1.32	.69	4.71	6.88		
2.625	3.265	3.625	3.531	2.46	1.80	1.32	.69	4.86	7.00		
2.750	3.577	3.938	3.843	2.63	1.96	1.46	.69	5.19	7.60		

7000G+ LARGE BORE ARRANGEMENT

A	B <sub>2</sub> min.	B <sub>2</sub> max.	C <sub>2</sub>	D <sub>2</sub>	E <sub>2</sub>	F <sub>2</sub>	G	H	I	J	
1.125	2.625	2.968	2.59	2.00	1.33	.98	.44	3.81	5.25	.44	
1.375	2.875	3.218	2.84	2.00	1.33	.98	.44	4.06	5.31	.44	
1.750	3.062	3.750	3.02	2.22	1.56	1.08	.56	3.98	6.13	.21	
1.875	3.187	3.875	3.15	2.22	1.56	1.08	.56	4.11	5.97	.21	
2.125	3.437	4.125	3.40	2.22	1.56	1.08	.69	4.36	6.50	.21	
2.500	3.812	5.187	3.77	2.22	1.56	1.08	.69	5.62	7.88	.21	SEE NOTE
2.625	3.937	4.625	3.90	2.22	1.56	1.08	.69	4.86	7.00	.21	
2.750	4.250	4.937	4.20	2.49	1.83	1.33	.69	5.19	7.60	.11	

NOTE: 2.500 7000G & 7000G+ GLAND & GLAND ADAPTERS ARE DIFFERENT.

TYPICAL ARRANGEMENT

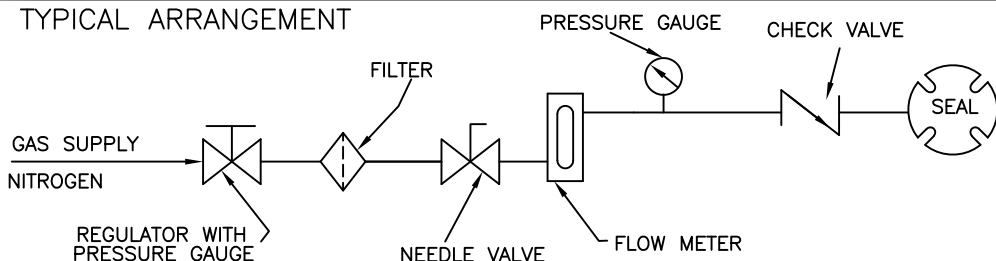

REV. E: NUMBERS IN COLUMNS D2, F1 & F2 CHANGED. 11-02-00 JKH/WWW  
 ADDED 1.125+ & 1.375+ FOR DURCO GPI.  
 REV. D: 1.375+ GLD O.D. TO 5.31. 08-13-99 CMM/WWW  
 REV. F: 1.875 OLD OD 6.25 TO 5.97. 05-28-14 MCW/WWW

FILENAME: F:\CAD-DWG\INSTALL\00001248.DWG

7000G GAS SEAL

<b>PPC MECHANICAL SEALS</b>			T-4693 -F
BATON ROUGE, LA.			
INITIALS	DATE	COMPUTER AIDED DESIGN	DWG. NO.
DRAWN BY CMM	02-01-98		
CHECKED BY WWW	02-01-98		